

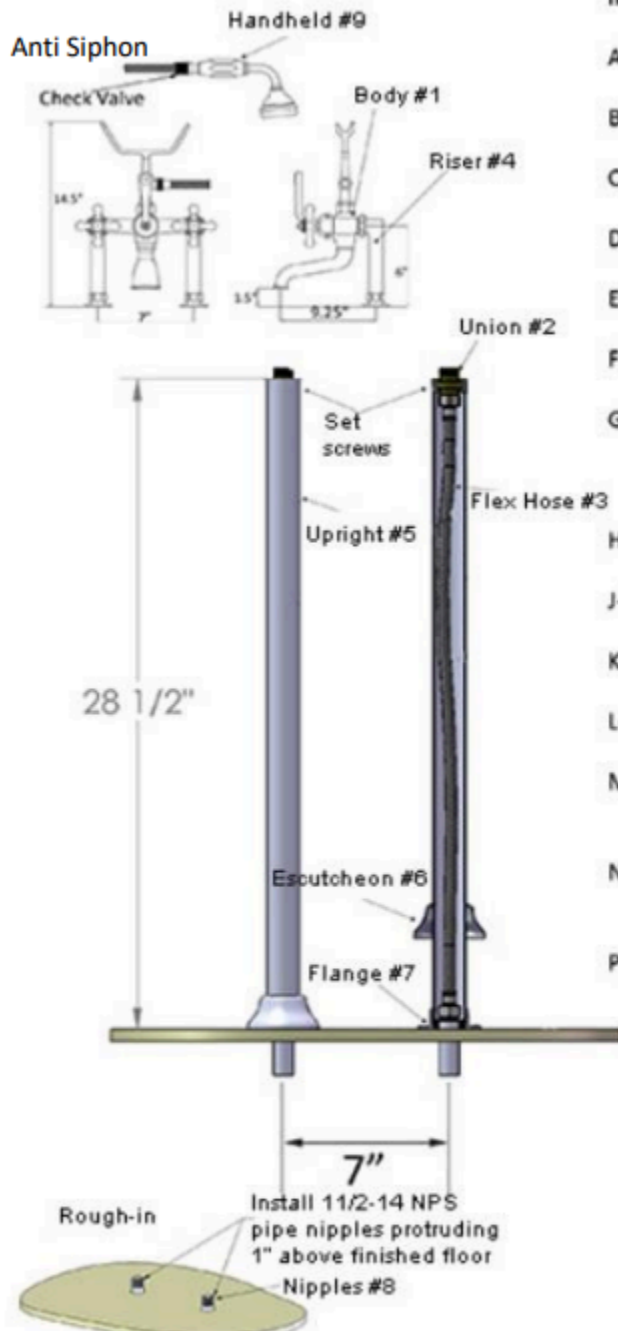

Victorian Faucet Specs

Floor Mounted Specs



Installation Steps

- A- Prepare rough in of Nipples #8
- B- Mark off holes for Flanges #7
- C- Attach Flanges #7 solidly to floor
- D- Attach Union #2 to Flex hose #3
- E- Attach assembly at D to Riser #4
- F- Slide Escutcheons #6 over uprights #5
- G- Loosen set screws on Uprights #5 and push assembly at point E inside Uprights #5
- H- Attach Flex Hose #3 to Nipples #8
- J- Attach Body #1 to Risers #4
- K- Support fixture and test for leaks
- L- Gently pull assembly at J out of Uprights #5
- M- Screw Uprights #5 all the way down into Flanges #7
- N- Push assembly at J back into Uprights #5 and tighten set screws
- P- Connect Handheld #9

Product is approved and listed in compliance with the following standards:
ASME A112.18.1-2018/CSA B125.1-18
MA Code Accepted

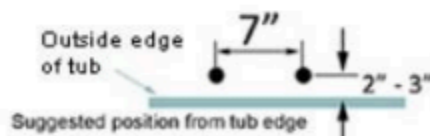



Wall Mounted Specs

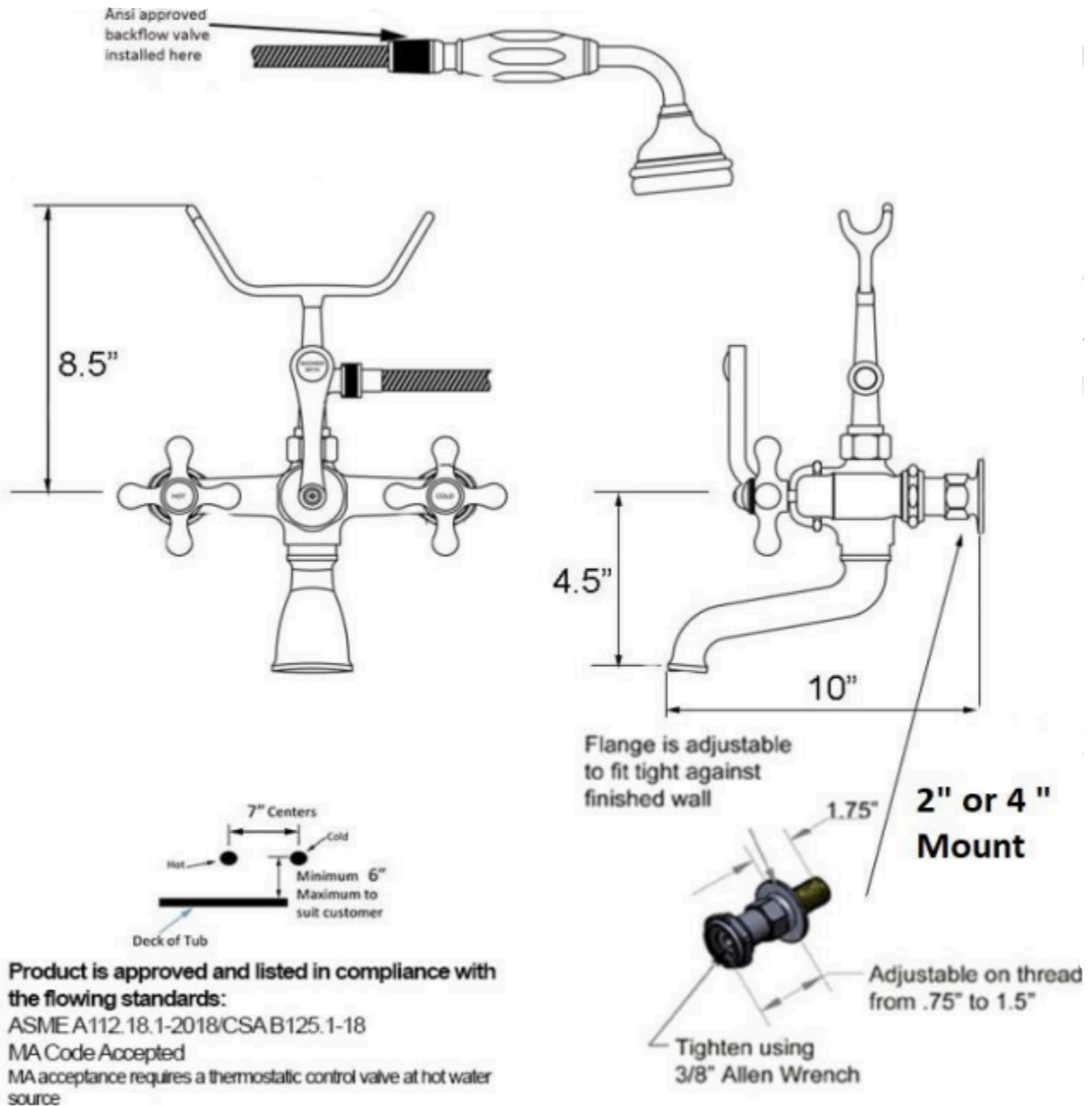



Tub Mounted Specs

Victoriana Faucet on Tub

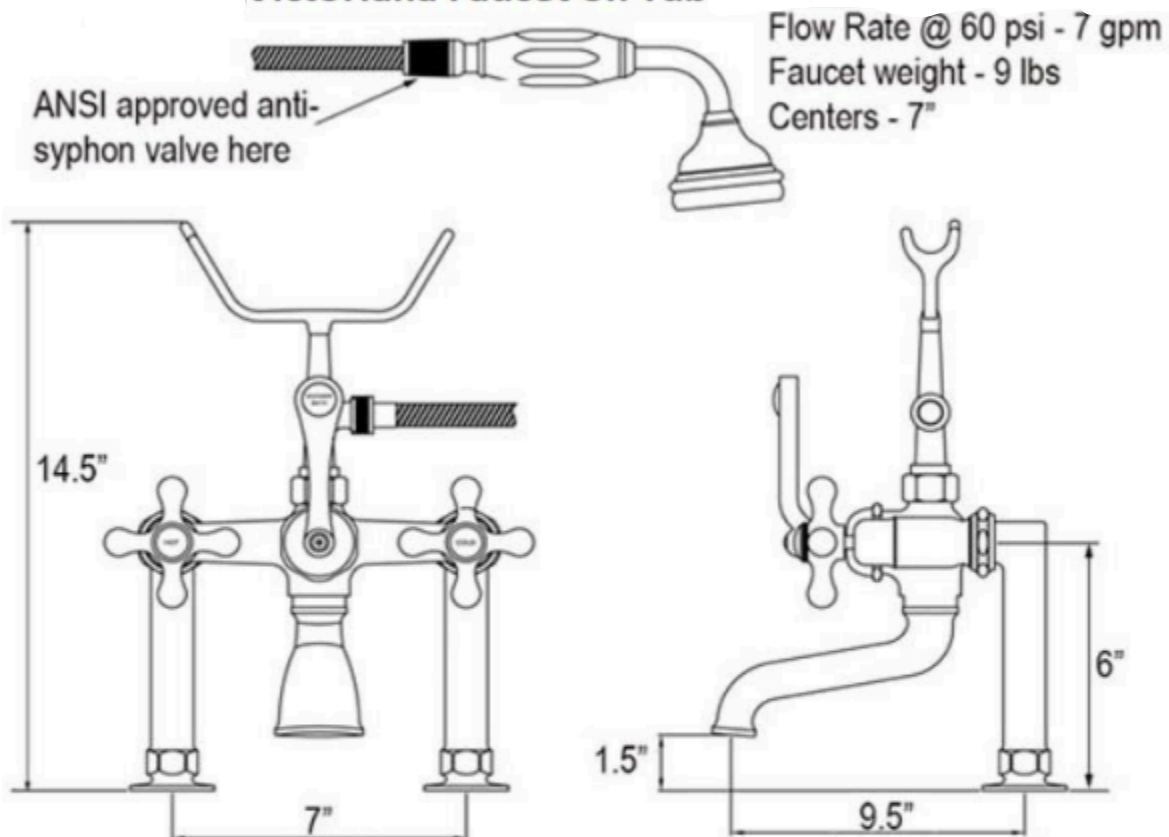

Product is approved and listed in compliance with the following standards:
ASME A112.18.1-2018/CSA B125.1-18
MA Code Accepted

We recommend and MA Code requires that a thermostatic control valve is used at water source. Should you require different water supply centers, adjusters, item # CAVic are available. Should you require additional length from the deck to the spout, 4" extension pieces item # EXT4 are available.